

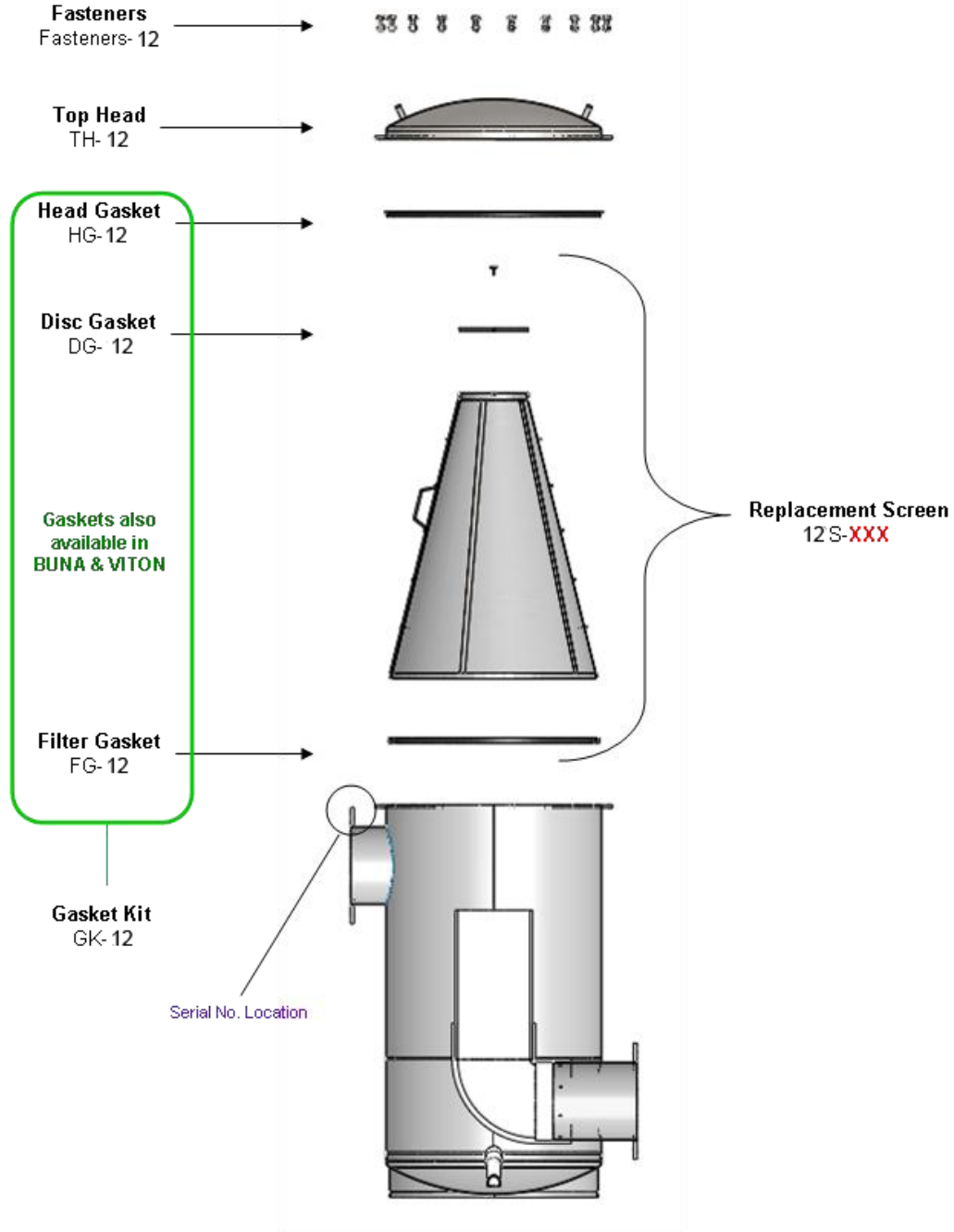

# Thompson Strainer - 12" Exploded View

## Complete Strainer MLS-12-**XXX**



**XXX** Denotes Mesh Options

Mesh Options – 16, 20, 30, 40, 50, 60, 80, 100, 120, 150, 200  
 Heavy Duty Mesh – 24x110, 30x150, 40x200, 50x250 (Dutch weave screens; heavier wire gauge, lower open area %)



**MILLER-LEAMAN**  
INCORPORATED

800 ORANGE AVENUE • DAYTONA BEACH, FLORIDA 32114  
 PHONE: 386.248.0500 • FAX: 386.248.3033 • TOLL FREE 800.881.0320  
 WWW.MILLERLEAMAN.COM • EMAIL: SALES@MILLERLEAMAN.COM