

# MILLER-LEAMAN

INCORPORATED

## Thompson Strainer Instrumentation Package Replacement Parts

### ***Automatic Timer Flush Package for Thompson Strainer***

<b><u>Valve &amp; Components</u></b>	<b><u>ATF-1</u></b>	<b><u>ATF-1.5</u></b>	<b><u>ATF-2</u></b>	<b><u>ATF-3</u></b>
PDA/ATF Complete Package	PDA/ATF-EA-1	PDA/ATF-EA-1.5	PDA/ATF-EA-2	PDA/ATF-EA-3
ATF Package Only	ATF-EA-1	ATF-EA-1.5	ATF-EA-2	ATF-EA-3
Replacement Valve, Electric Actuator (valve and actuator)	PS00581	PS00582	PS00583	PS01209
Replacement Valve, Electric Actuator (valve only)	PS01198	PS01199	PS01200	PS01207
Replacement Valve, Electric Actuator (actuator only)	PS01201	PS01202	PS01203	PS01208
Valve Seal Repair Kit	PS01204	PS00854	PS01205	PS01206

<b><u>Controller &amp; Misc (same price for all size ATF)</u></b>	<b><u>P/N</u></b>
ATF Control Box (box only: no valve, incl power supply)	ML21053-A
Timer Control Relay (inside control box)	PS00587
Power Supply (wall plug in)	ATFR-2000
Twisted Cable (to connect to PDA)	ML10808
On/Off Switch	PS00588

#### **Misc. Valve Components**

See page 2, exploded view

### ***Pressure Differential Alarm Package for Thompson Strainer***

<b><u>Component</u></b>	<b><u>P/N</u></b>
Pressure Differential Alarm	PDA
Pressure Differential Gauge	PS00059
Circuit Board	ML20945
Power Supply (wall plug in)	ATFR-2000
Twisted Cable (to connect to ATF)	ML10808
Red Warning Light	PS00685
Reset Button	PS00702
Audible Alarm	PS00691

# ATF-EA-1.5 Automatic Timer Flush Valve Replacement Part List

## Exploded Parts View

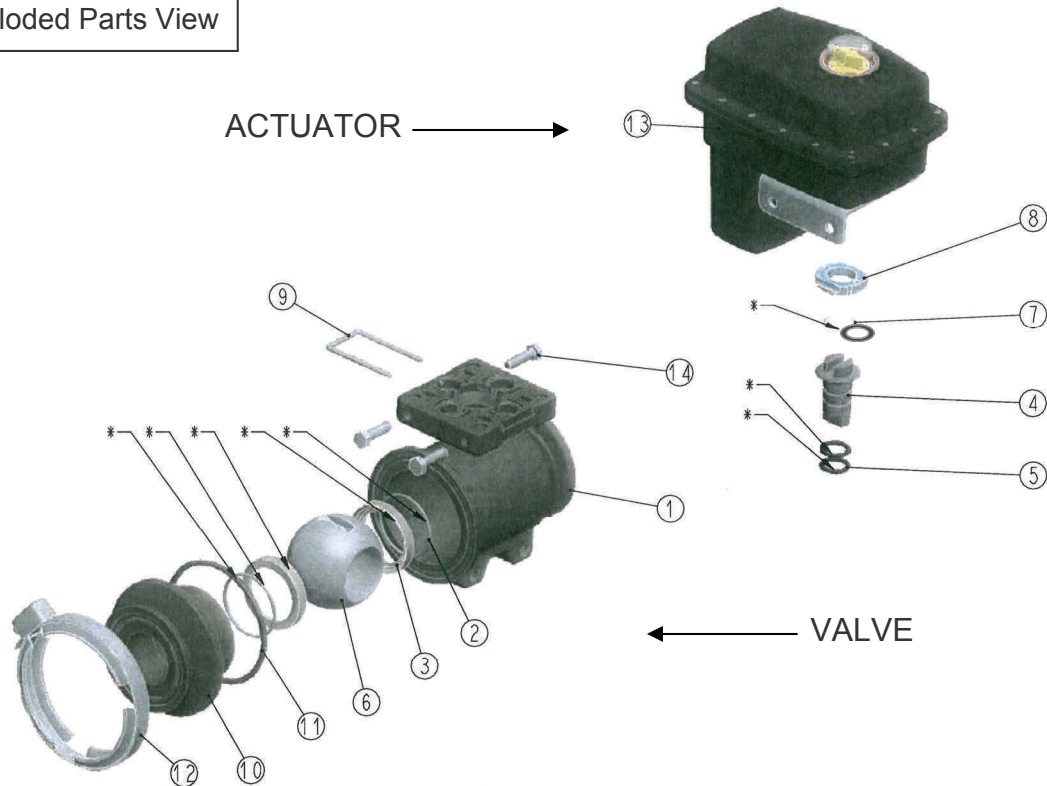

## Price List

No.	Part No.	Description	
1	PS00850	Valve Body, 2-Way 1.5" FNPT	
4	PS01181	Stem, SS	
6	PS01182	Valve Ball SS	
8	PS01183	Stem Retainer Bushing	
9	PS01184	Hair Pin SS	
10	PS00851	1.5" FNPT Adapter	
12	PS01185	V-Clamp SS	
13	PS01202	EH2 Actuator	
14	PS90727	Bolt 1/4" - 20 x 1" SS (set of 3)	
*	PS00854	Valve Repair Kit, includes:	
2	kit PS00854	O-Ring, #131, EPDM (2)	
3	kit PS00854	Seat, PTFE (2)	
5	kit PS00854	O-Ring, #113, VITON (2)	
7	kit PS00854	Thrust Washer	
11	kit PS00854	O-Ring, #236, EPDM	