

**Thompson Strainer - 4" Exploded View**

**Complete Strainer**  
 MLS-04B-**XXX**

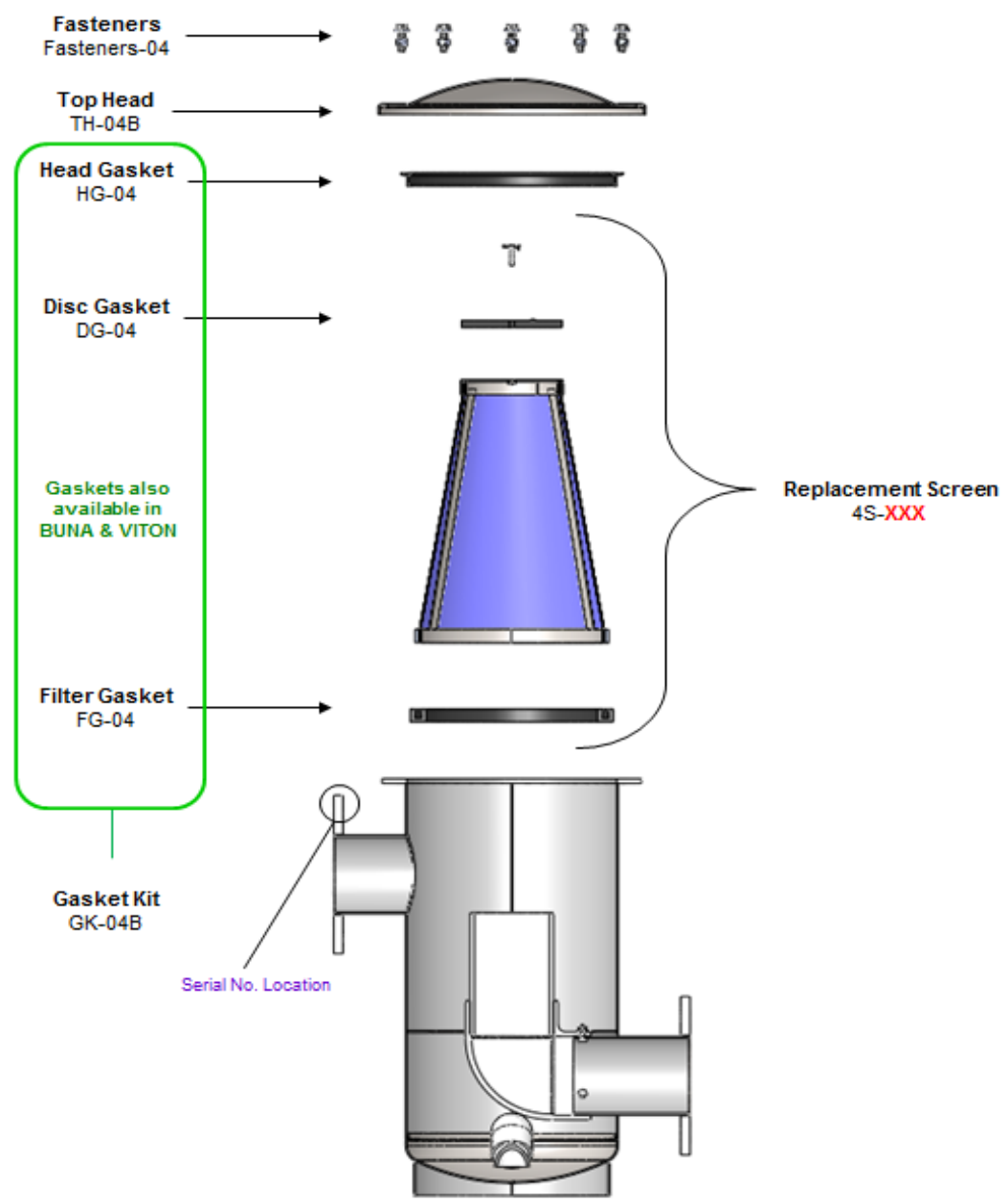

**XXX** Denotes Mesh Options

Mesh Options – 16, 20, 30, 40, 50, 60, 80, 100, 120, 150, 200  
 Heavy Duty Mesh – 24x110, 30x150, 40x200, 50x250 (Dutch weave screens; heavier wire gauge, lower open area %)

