

GENERAL SPECIFICATIONS	
DESIGN FLOW RANGE (GPM)	60~130
PUMP DISCHARGE RANGE (PSI)	35~26
MAX SYSTEM PRESSURE (PSI)	125
MAX SUPPLY PRESSURE (PSI)	85
FILTRATION AREA (SQ IN)	122
MAX TEMP (°F)	135
VOLUME (US GAL)	2
DRY WEIGHT (LBS)	121
MAIN PUMP	3 HP
ELECTRICAL: 460VAC/3Ph/60Hz/5A	

MATERIALS		
HOUSING / SCREEN FRAME		304SS
SCREEN		316SS
GASKETS		EPDM
ELBOW & RISER PIPE		304SS
SKID / FRAME		304SS
PUMP CASING		316SS
CONICAL FILTER ELEMENT		
PERFORATED SCREEN		1/4"
MESH SCREEN		TBD
SCREEN HEIGHT (IN)		9.48

NOTES
CLEARANCE ABOVE STRAINER EQUAL TO SCREEN HEIGHT REQUIRED FOR SERVICE

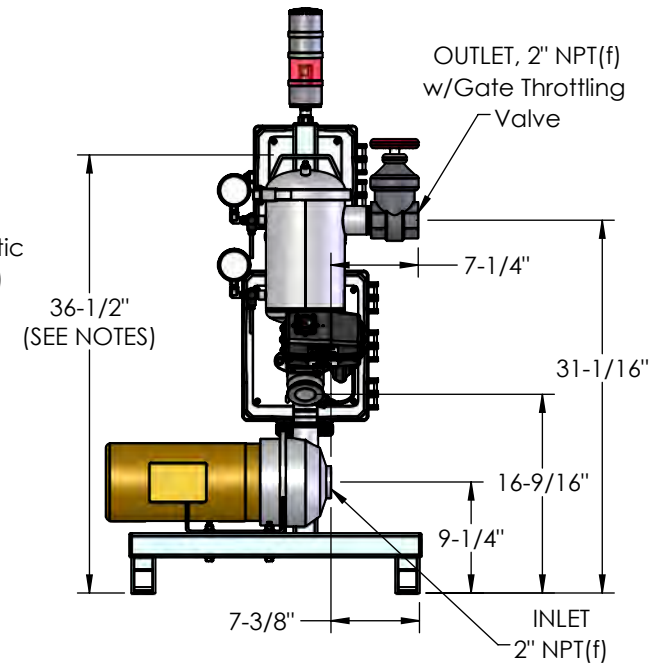
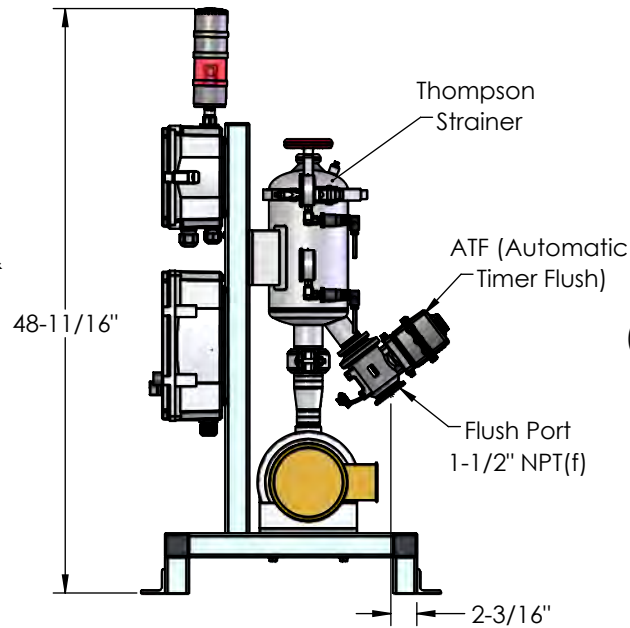
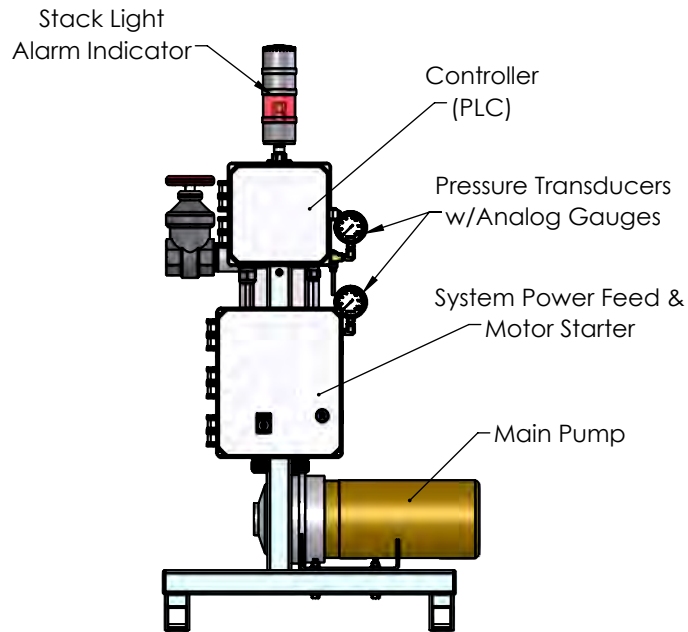

PRODUCT SPECIFICATION

MILLER LEAMAN
800 Orange Avenue, Daytona Beach, FL 32114

Dimensions are for reference only.	
CUST. REF.	
PREV. MOD.	
ENG. REF.	ML20623
DWG. DATE	3/18/21
	SHEET 1 of 1

SERIES: THOMPSON	MODEL: PUMP SKID
CONFIGURATION: MLS-2 Skid System	

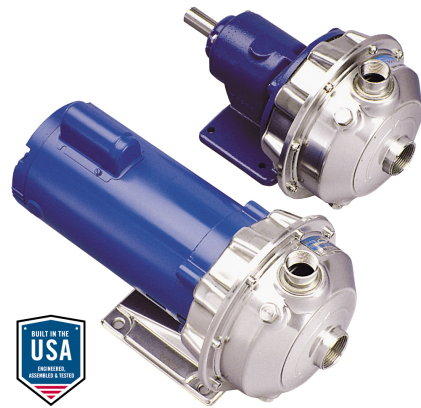

Customer	Date	22.06.2021
Contact	Project	
Phone number	Project no.	
Email		

3ST1H9D4

Operating data

Pump type	Single Stage End Suction Pumps		Fluid	Water
No. of pumps/ Reserve	1 / 0		Operating temperature t A °F	39.2
Nominal flow	US g.p.m.	130	pH-value at t A	7
Nominal head	ft	60.4	Density at t A	lb/ft ³ 62.4
Static head	ft	0	Kin. viscosity at t A	ft ² /s 1.689E-5
Inlet pressure	psi	0	Vapor pressure at t A	psi 14.5
Environmental temperature	°F	68	Solids	0
Available system NPSH	ft	0	Altitude	ft 0

Pump data

Make	Goulds Water Technology		Nominal	US g.p.m.	130	(130)
Speed	rpm	3500	Flow	Max-	US g.p.m.	145
No. of stages		1		Min-	US g.p.m.	
Max. casing pressure	psi		Nominal	ft	60.4	
Max. working pressure	psi	36	Head	at Qmax	ft	52.2
Head H(Q=0)	ft	83		at Qmin	ft	83.1
Weight	lb	55	Shaft power	hp	3.2	(3.2)
	Max.	inch	Max. shaft power	hp	3.3	
Impeller R	designed	inch	Efficiency	%	62.11	
	Min.	inch	NPSH 3%	ft	10.3	

Shaft Seal

Make	John Crane
Type of Shaft Seal	Type 21
Seal Material Code	Car-SilCar-Viton (10K55)
1 - Rotating	Carbon
2 - Stationary	Silicon Carbide
3 - Elastomers	Viton
4 - Metal Parts	316 SS

Motor data

Manufacturer	BMW	Electric voltage	208 V	Speed	3500 rpm
Specific design	3ph TEPE	Electric current	7.6 A	Frame size	56J
Type	208-230/460V 56J (E09C32E5EB2G)	Rated power	3 hp	Insulation class	B
		Degree of protection	IP 55	Colour	RAL 5010

Remarks:

Customer	Date	22.06.2021
Contact	Project	
Phone number	Project no.	
Email		

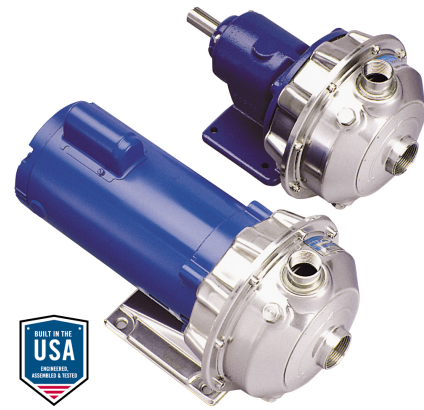

3ST1H9D4

Pump Materials

100 - Casing	AISI 316L SS
101 - Impeller	AISI 316L SS
108 - Motor adapter	AISI 316L SS
108A - Motor adapter seal vent/flush	AISI 316L SS
123 - Deflector	BUNA-N
184 - Seal housing	AISI 316L SS
184 A - Seal housing seal vent/flush	AISI 316L SS
347 - Guide vane	AISI 316L SS
349 - Seal ring, guide vane	Viton
370 - Socket head screws, casing	AISI 410 SS
371 - Bolts, motor	Plated Steel
383 - Mechanical seal	Refer Mechanical Seals
408 - Drain and vent plug, casing	AISI 316L SS
412B - O-ring, drain and vent plug	Viton (Standard), EPR (Optional)
513 - O-ring, casing	Viton (Standard), EPR (Optional)
Motor - NEMA standard, 56J flange	-

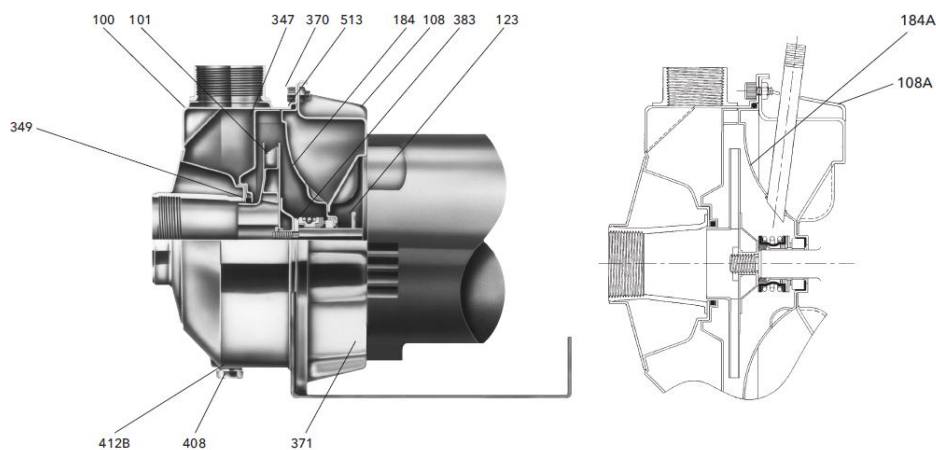

Remarks:



Customer	Date 22.06.2021
Contact	Project
Phone number	Project no.
Email	

3ST1H9D4

Hydraulic Data

Operating Data Specification		Hydraulic data (duty point)		Impeller design	
Flow	130 US g.p.m.	Flow	130 US g.p.m.	Impeller R	4 inch
Head	60.4 ft	Head	60.4 ft	Frequency	60 Hz
Static head	0 ft			Speed	3500 rpm

Power data referred to:
Water [100%] ; 39.2°F; 62.4lb/ft³; 1.69E-5ft²/s
Performance according to ISO 9906:2012 – Grade 3B

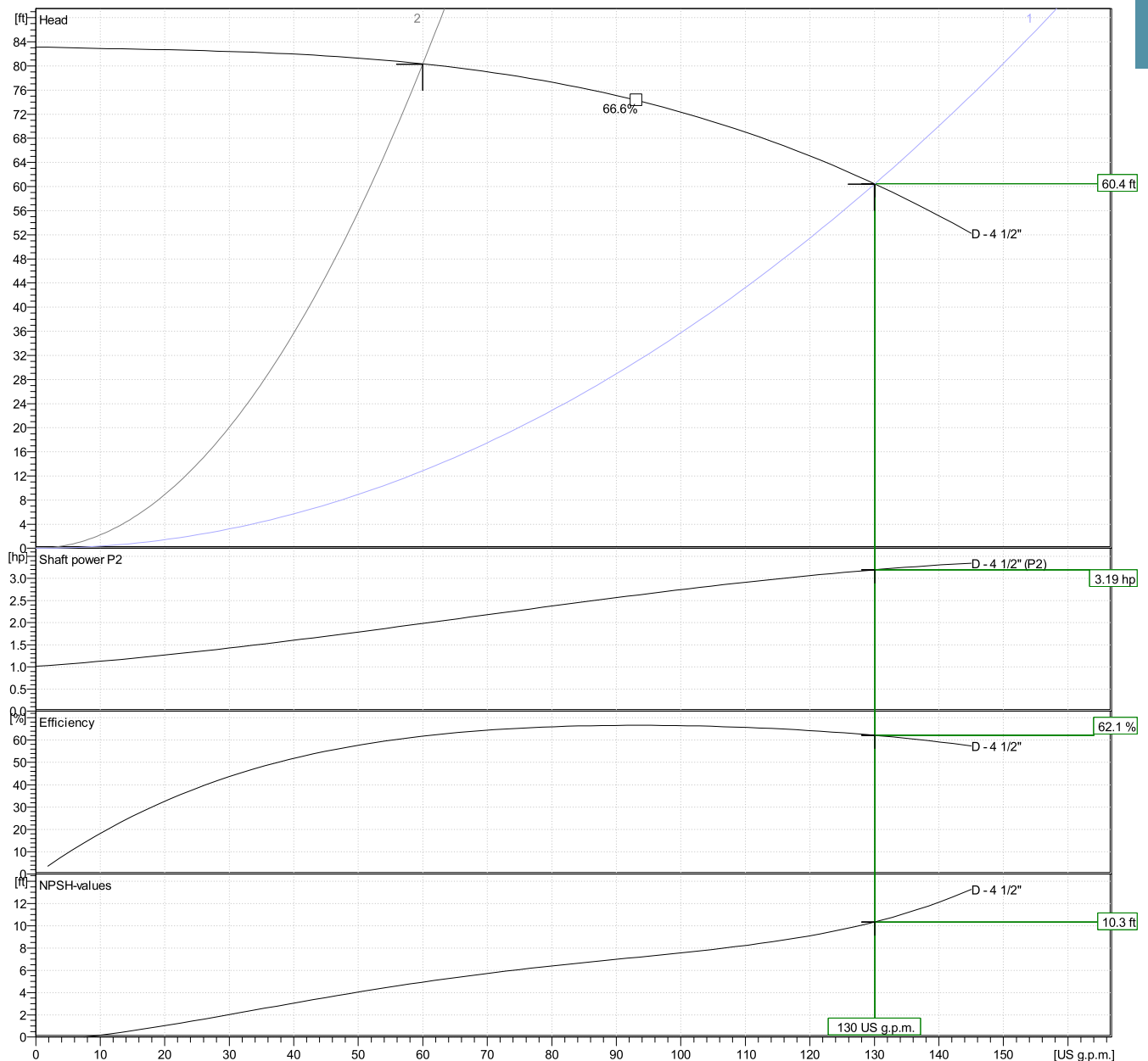



Customer	Date 22.06.2021
Contact	Project
Phone number	Project no.
Email	

3ST1H9D4

Drawing

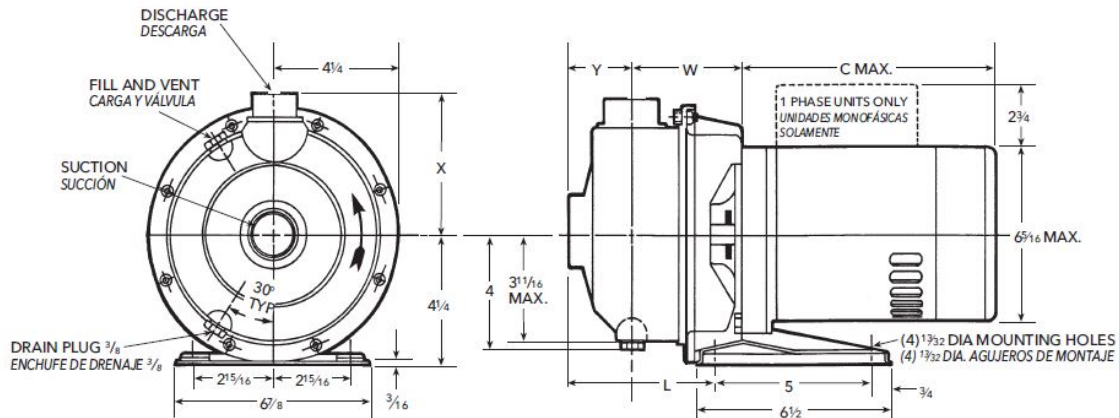

ODP* and TEFC* 1/2, 3/4 and 1 HP (standard), ODP* y TEFC* 1/2, 3/4 y 1 HP (estándar)

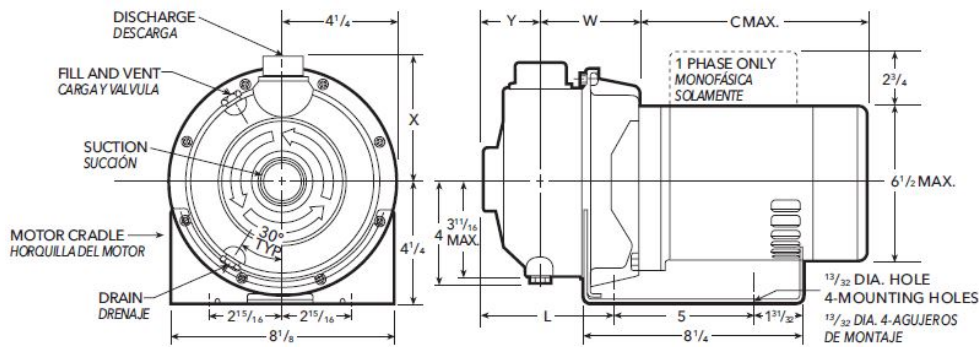

ODP* and TEFC* 1 1/2, 2, 3 and 5 HP (standard), ODP* y TEFC* 1 1/2, 2, 3 y 5 HP (estándar)

Dimensions inch

Dimensions	Value
Motor Dim. C(Max) Length	15 ³ / ₈
Motor Dim. P(Max)	7 ³ / ₁₆
Pump Dim. Discharge NPT	1 ¹ / ₂
Pump Dim. L	5 ¹ / ₈
Pump Dim. M	8 ¹ / ₂
Pump Dim. Suction NPT	2
Pump Dim. W	3 ³ / ₄
Pump Dim. X	4 ⁵ / ₈
Pump Dim. Y	2 ¹ / ₈

Weight	55	lb
--------	----	----